

Type HCW31

Pre-galvanised strip

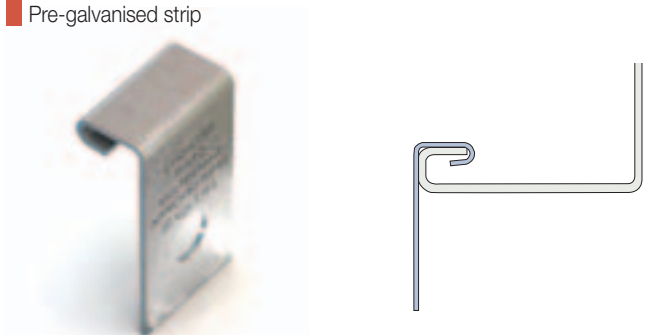

A universal purlin clip suitable for multiple different applications.

Product Code	Purlin	Safe Working Load (3:1 Factor of Safety)	
		Tensile	kN
HCW31	Kingspan Multibeam 3	0.2	

Order example: HCW31

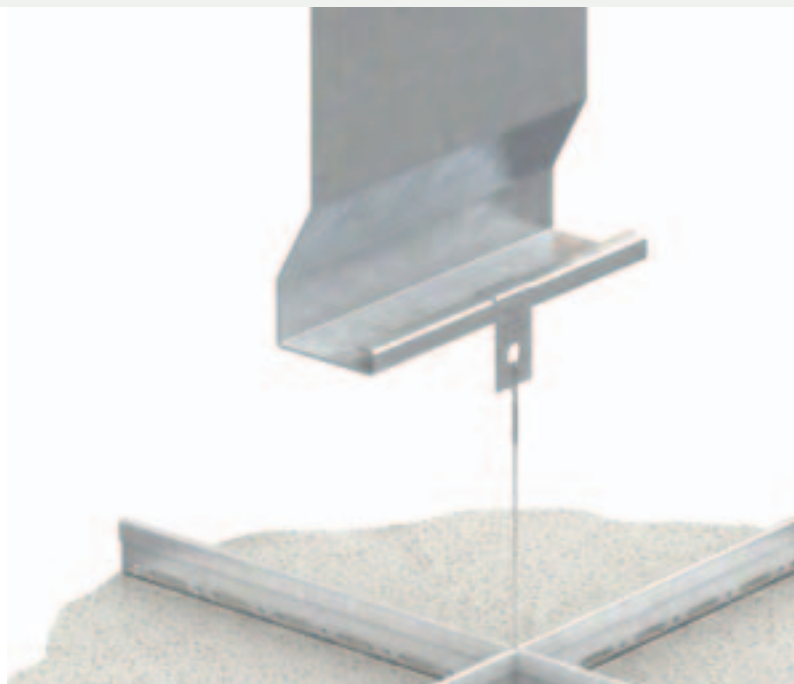

Type WF

Mild Steel, bright zinc plated

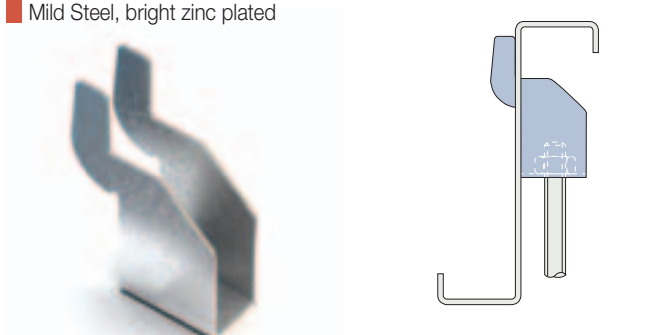

The Webfix – WF for a quick installation directly from the web of Zed purlins.

Product Code	Rod	Safe Working Load (5:1 Factor of Safety)		Hole Ø	Max. Distance X at Angle of		
		Tensile	Max. Purlin Thickness		10°	20°	30°
WF10	M10	1.0	4	18	103	94	74

Order example: WF10



Installation

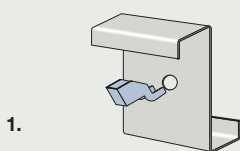

1. Squeeze legs of WF together and push through hole until it snaps into place.

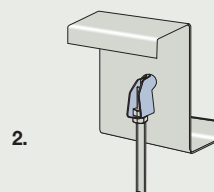

2. Assemble with nut and ensure full thread capture.

Hole position for angled purlins

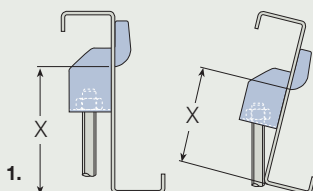

1. Canted Purlins: As the angle of backwards cant increases, the maximum allowable distance X (hole centre to bottom edge of purlin) must decrease.

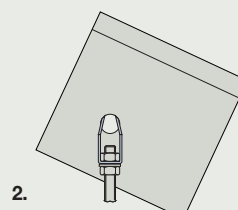

2. Inclined Purlin: The WF adjusts to whatever angle is required. Hole position is not a limiting factor on product installation.