

Type BR

Malleable iron, bright zinc plated / hot dip galvanised

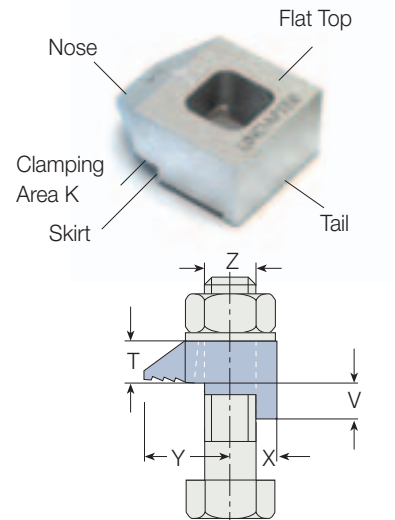

Versatile clamp for steel beams or rails. The skirt prevents the clamp rotating during installation. The BR tail spans slotted holes. Suitable for flanges up to 8°.

Product Code	Bolt 8.8 Z	Safe Working Loads (5:1 Factor of Safety)			Torque Nm	Y mm	X mm	Dimensions Tail Length V			Width mm
		Tensile / 1 Bolt kN	Frictional / 2 Bolts kN	short mm				medium mm	T mm		
BR12	12	5.8	0.7	69	26	13	4	6	13	29	
BR16	16	7.3	1.5	147	30	16	6	8	16	35	
BR20	20	14.7	3	285	36	19	7	10	19	42	
BR24	24	19.7	4.5	491	48	25	9	12	25	54	

Order example: BR12 short HDG

Type RC

Forged steel, corrosion protection as required

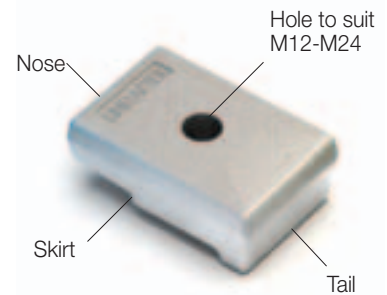
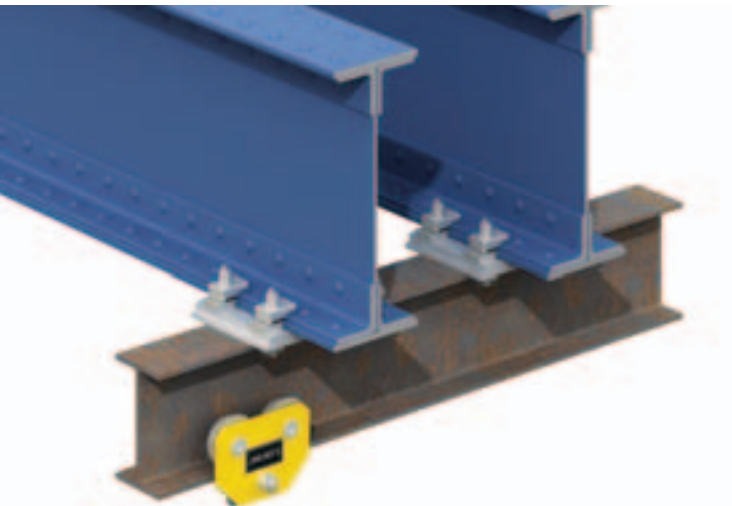

Special clamp to secure rails or steel beams of 10mm or greater. Packings are available for thicker flanges. The RC tail spans slotted holes. Suitable for flanges up to 5°. The product will be drilled to suit hole size and position requirements of the applications.

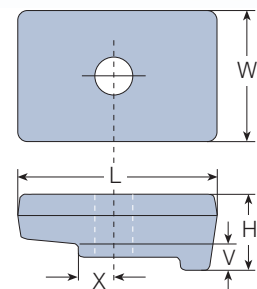

Product Code	Bolt 8.8 Z	Min. Safe Working Load ¹⁾ (5:1 Factor of Safety)		Torque Nm	Tail Length V mm	X mm	Dimensions		
		Tensile / 1 Bolt kN					L mm	H mm	Width W mm
RCS12	M12	2.6		69	10	6.5 - 26.5	76	29	50
RCS16	M16	4.0		147	10	9 - 24	76	29	50
RCS20	M20	9.6		285	10	11 - 22	76	29	50
RCS24	M24	12.3		491	10	13 - 20	76	29	50

¹⁾ The safe working load depends on the position of the bolt hole. The greater dimension X the lower the load.

Order example: RCS12 HDG with dimension X = _____ mm